

Procheck 125

VAPOUR CONTROL

DESCRIPTION

Vapour Control Layer

Procheck 125 is a reinforced polyethylene vapour barrier which can be utilised in a variety of commercial applications. Procheck 125 can be installed where very high moisture vapour resistance is not a necessity but a strong, airtight membrane is.



Ground Separating Layer

Procheck 125 can also be used as a separating layer above Provoid 25 Gas Venting Layer to prevent grout from the concrete pour entering into the void. This will only be used when the Protech Gas Membrane is going to be placed above the slab. It can be loose laid on the Provoid 25 Gas Venting Layer with a 300mm lap.

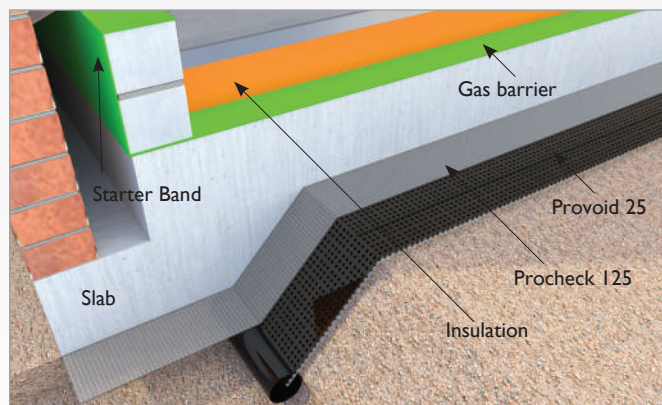

Advantages

- Vapour Resistance- 126 MNs/g
- Reinforced
- Translucent
- Low / Medium Risk Applications eg. infrastructure, light commercial buildings

Physical Properties	Result
BS EN 13984:2013	
Roll size	2m x 50m
Nominal Weight	90 gsm
Nominal Thickness	0.35mm
Tensile Strength along the roll across the roll	186 N / 50mm 126 N/ 50mm
Nail Tear Resistance along the roll across the roll	195 N 210 N
Water Vapour Resistance	Sd 25m



Download a brochure from our website...
www.proctorgroup.com



contact@proctorgroup.com | +44 (0) 1250 872261

Revised: July 2025 Version: 1.004 Next review due: July 2026