



ResoDeck 28PRO

Product Information & Technical Data Sheet

Resonate's **ResoDeck 28PRO** is a high performance acoustic flooring solution suitable for use on timber and concrete separating floors. The composite acoustic overlay panel is laid as a floating floor on top of the timber or concrete sub-floor, before the final floor coverings (carpet, laminate etc) are installed.

Easy Install Soundproofing

The 28mm thick **ResoDeck 28PRO** panels have minimal impact on floor height. The 18mm (22mm option available) P5 chipboard top layer is technically bonded to 10mm **ResoFleece** a high performance fibre resilient layer.

The **ResoFleece** resilient layer provides superior impact sound reduction, making it ideal for residential properties that require excellent reduction of foot fall noise. The tongue and groove edge detail allows for fast and simple installation, perfectly suited for refurbishment applications.

Key Benefits



Excellent impact sound reduction



Easy to install tongue and groove edge

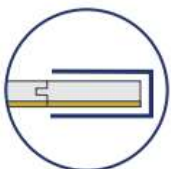

Low profile solution, low impact on floor height

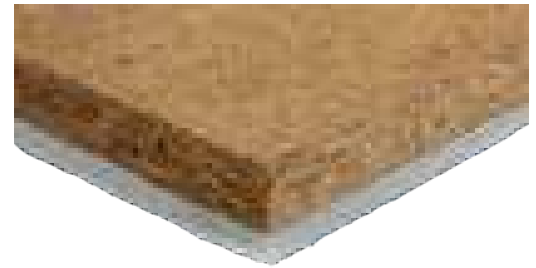

System Details

1. Resonate **ResoDeck** floor panel
2. **ResoEdge** flanking strip

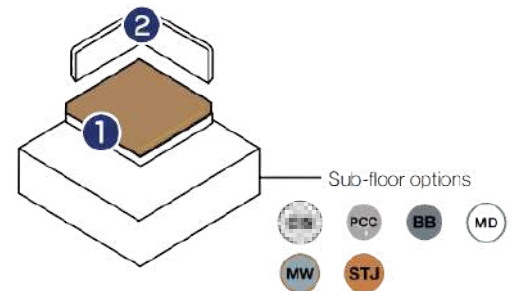

Dimensions

Panel Dimensions

600mm (W)
2400mm (L)
28mm (H)

Panel Weight

13.7 kg/m²
19.7 kg Per Panel

Panels Per Pallet

70 Panels (100.8 m²)

Panel m²

1.44 m² Per Panel

Pallet Dimensions

2400 mm (W)
1200 mm (L)
1100 mm (H)

Pallet Weight

1440 kg

Robust Detail Compliant

E-FC-1 (FFT 5)

E-FC-2 (FFT 5)

E-FS-1 (FFT 5)



Product Applications

Concrete In-situ Floor

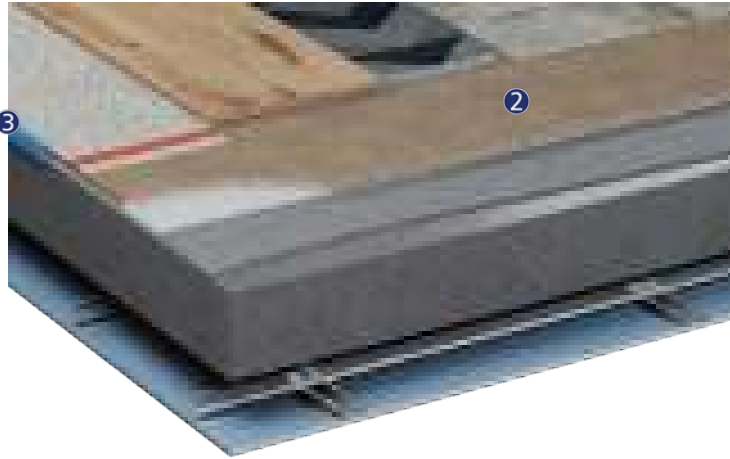

1. Ceramic Tiles / Timber flooring / Carpet / Vinyl
2. Resonate **ResoDeck 28PRO**
3. **ResoEdge L30** flanking strip
4. Levelling compound to achieve SR2 flatness
5. 200mm Reinforced insitu concrete slab
6. MF Ceiling (min 100mm void)
7. 1 x 9.5mm acoustic plasterboard

Airborne Sound Performance DnT,w + Ctr	51 dB
Impact Sound Performance LnT,W	49 dB
Impact Noise Improvement ΔLw	21 dB



Solid Timber Joisted Floor

STJ

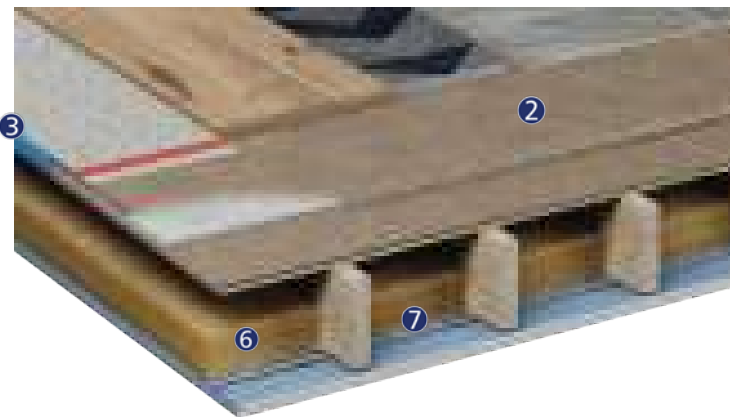

1. Ceramic Tiles / Timber flooring / Carpet / Vinyl
2. Resonate **ResoDeck 28PRO**
3. **ResoEdge L30** flanking strip
4. 18mm (min) timber sub floor
5. 200 (min) timber floor joists
6. **ResoQuilt** 50mm soundproofing wool
7. 30mm **ResoBar** resilient bars
8. 2 x 15mm acoustic plasterboard

Airborne Sound Performance DnT,w + Ctr	50 dB
Impact Sound Performance LnT,W	55 dB



Profiled Metal Deck Floor



1. Laminate Flooring
2. Adhesive or decoupling layer
3. Resonate **ResoDeck 28PRO**
4. **ResoEdge L30** flanking strip
5. Levelling compound to achieve SR2 flatness
6. 130mm concrete on profiled metal deck
7. MF Ceiling (min 100mm void)
8. 1 x 9.5mm acoustic plasterboard

Airborne Sound Performance DnT,w + Ctr	51 dB
Impact Sound Performance LnT,W	50 dB



Performance figures shown are for indicative purposes only. For technical advice specific to your project please contact Resonate Systems technical team.

www.resonatesystems.co.uk \ technical@resonatesystems.co.uk