

SP-3JB CONNECTABOX

Product User Manual / Datasheet

1 Product information

- Tough weatherproof enclosure
- IP65 rated
- Allows easy and quick installation of Solco Pyroelec trace heating cables
- Very versatile and can be used to make power, end, splice, tee or elbow connections
- Applicable pipe mounting bracket kit available separately - model number SP-BRP-001

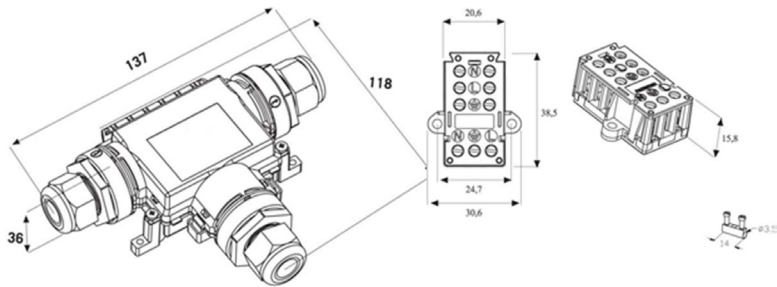

Technical drawing with dimensions

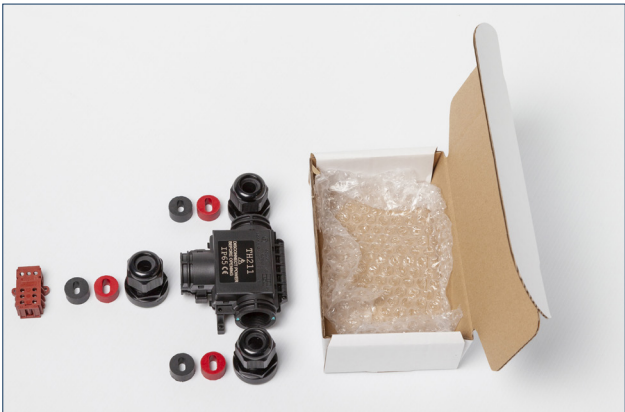

Complete kit contents

2 Technical specification

Cable entries	3
Body material	PA66/SEBS/TPE
IP rating	65
Minimum temperature rating (°C)	-40
Maximum temperature rating (°C)	125
Cable termination system	3 x 3 terminals, 32A, 450V.
Comments	This product comprises junction box, 2 lid screws terminal block, 3 cable glands & 6 cable sealing EPDM grommets

Solco Pyroelec UK Limited
Unit 11, Kenyon Business Park
Pilkington Street , Bolton BL3 6HL

Email: enquiries@solcopyroelec.co.uk

Telephone: +44 (0)1204 869449

Web: www.solcopyroelec.co.uk





SP-3JB CONNECTABOX

Product User Manual

3 Installation

1. Select the correct seal as per the table below:

Grommet/seal selection table

Item	Description	Image
a.	M25 gland body, cap and lock nut	
b.	Power cable sealing grommet Minimum cable diameter - 7mm Maximum cable diameter - 13.5mm	
c.	Heating cable sealing grommets	
		<div>Applicable cables: HSR/FBL 10, 16, 24 VSR 16, 24, 30, 40 FBH 15, 30, 45 FBX, FBZ all IPSR</div> <div>Applicable cables: HSR/FBL 30 VSR 50 FBH 60 HWS-R/HWS-P</div>

- Slide cable glands supplied back onto each power/heating cable.
- Terminate heating cable using appropriate Solco Pyroelec power termination kit (sold separately):
 - Heatshrink kit, model PYEX-PTK-S
 - 'Cold' silicon kit, model SP-PTK-M
- Affix the CONNECTABOX body in a secure location OR to mounting bracket supplied by Solco Pyroelec.
- Connect each heater to appropriate point in the terminal block and screw down tightly using appropriate torque level. NOTE - the terminal block can be removed by sliding out of the groove for easy connection and replaced into the groove after connection.
- Close the lid ensuring the power and heating cables line up in each gland channel. The lid will click shut and should be made secure using the 2 screws provided.
- Slide each gland forward and tighten using appropriate torque level.

Approvals



Made in United Kingdom

Solco Pyroelec UK Limited
Unit 11, Kenyon Business Park
Pilkington Street, Bolton BL3 6HL

Email: enquiries@solcopyroelec.co.uk

Telephone: +44 (0)1204 869449

Web: www.solcopyroelec.co.uk

